

BEFORE THE ILLINOIS POLLUTION CONTROL BOARD

| | | |
|---|---|----------------------------|
| Wabash Valley Service Company - Oblong |) | |
| (Property Identification Number |) | PCB No. 25 - |
| 04-1-33-000-010) |) | (Tax Certification) |
| |) | |

NOTICE

PLEASE TAKE NOTICE that I have today filed with the Office of the Clerk of the Pollution Control Board an **APPEARANCE** and **RECOMMENDATION OF THE ILLINOIS ENVIRONMENTAL PROTECTION AGENCY**, copies of which are herewith served upon you.

Wabash Valley Service Company - Oblong
Kent Ochs
909 N. Court Street
Grayville, Illinois 62884

Don Brown, Clerk
Illinois Pollution Control Board
60 East Van Buren Street, Suite 630
Chicago, Illinois 60605

Copies also provided electronically as follows:

Illinois Department of Revenue
via email at REV.PropTaxApp@illinois.gov
101 West Jefferson
P.O. Box 19033
Springfield, Illinois 62794

ILLINOIS ENVIRONMENTAL PROTECTION AGENCY

By: 
Amanda Kimmel
Assistant Counsel
Division of Legal Counsel

DATED: December 3, 2024

Illinois Environmental Protection Agency
1021 North Grand Avenue East
Post Office Box 19276
Springfield, Illinois 62794-9276
(217) 782-5544

THIS FILING IS SUBMITTED ON RECYCLED PAPER

BEFORE THE ILLINOIS POLLUTION CONTROL BOARD

| | | |
|---|---|----------------------------|
| Wabash Valley Service Company - Oblong |) | |
| (Property Identification Number |) | PCB No. 25- |
| 04-1-33-000-010) |) | (Tax Certification) |
| |) | |

A P P E A R A N C E

The undersigned, as one of its attorneys, hereby enters an **APPEARANCE** on behalf of Respondent, Illinois Environmental Protection Agency.

ILLINOIS ENVIRONMENTAL PROTECTION AGENCY

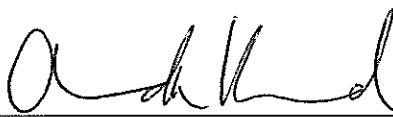
By: 
Amanda Kimmel
Assistant Counsel
Division of Legal Counsel

DATED: December 3, 2024

Illinois Environmental Protection Agency
1021 North Grand Avenue East
Post Office Box 19276
Springfield, Illinois 62794-9276
(217)782-5544

THIS FILING IS SUBMITTED ON RECYCLED PAPER

BEFORE THE ILLINOIS POLLUTION CONTROL BOARD

| | | |
|---|---|----------------------------|
| Wabash Valley Service Company - Oblong |) | |
| (Property Identification Number |) | PCB No. 25- |
| 04-1-33-000-010) |) | (Tax Certification) |
| |) | |

**RECOMMENDATION OF THE ILLINOIS
ENVIRONMENTAL PROTECTION AGENCY**

The Illinois Environmental Protection Agency ("Illinois EPA") hereby files its Recommendation pursuant to Section 125.204 of the regulations of the Illinois Pollution Control Board ("Board"), 35 Ill. Adm. Code 125.204.

1. On November 28, 2023, the Illinois EPA received a request from Wabash Valley Service Company - Oblong (Log number TC-148664, Exhibit A) for an Illinois EPA recommendation regarding the tax certification of water pollution control facilities pursuant to 35 Ill. Adm. Code 125.204.
2. The facility's address is: Wabash Valley Service Company - Oblong
10154 N. 450th Ave.
Oblong, Illinois 62449

The proposed water pollution control facilities in this request are located in the Section 33, T7N, R13W of the 2nd P.M. in Crawford County, at the above street address and consist of the following agrichemical containment structures:

One (1) dry fertilizer storage building measuring 81 ft. (length) x 101 ft. (width) constructed of reinforced concrete walls (entire building is used for dry fertilizer storage). Total estimated storage capacity of 2,700 tons.

One (1) operational containment structure measuring 52 ft (width) x 117 ft. (length) constructed of reinforced concrete. End loader transfer of bulk fertilizer between storage and the blender, unloading of bulk dry fertilizer transportation and application equipment, and the blending of bulk dry fertilizer is performed in this area.

One (1) operational containment structure measuring 12 ft. (width) x 16 ft (length) constructed of reinforced concrete. The bulk dry fertilizer bucket elevator is located upon this structure.

One (1) operational containment structure measuring 20 ft. (width) x 30 ft. (length) constructed of reinforced concrete. Loading of bulk dry fertilizer transportation and application equipment is performed upon this structure.

These agrichemical facilities collect, store, or prevent the comingling of precipitation with agrichemical rinsates, residues, or washwaters prior to reuse or disposal as approved under the Agency endorsed Agrichemical Facility Permit No. AC91070680 (Log No. 21113480 issued on December 24, 2021).

3. Section 11-10 of the Property Tax Code, 35 ILCS 200/11-10 (2022), and Section 125.200(a) of the Board's regulations, 35 Ill. Adm. Code 125.200(a), define "pollution control facilities" as:

any system, method, construction, device or appliance appurtenant thereto or any portion of any building or equipment, that is designed, constructed, installed or operated for the primary purpose of: eliminating, preventing, or reducing air or water pollution ...or treating, pretreating, modifying or disposing of any potential solid, liquid or gaseous pollutant which if released without treatment, pretreatment modification or disposal might be harmful, detrimental or offensive to human, plant or animal life, or to property.

4. In order to receive preferential tax treatment as pursuant to 35 ILCS 200/11-5 (2022), pollution control facilities must be certified as such by the Board, 35 ILCS 200/11-20 (2022) and 35 Ill. Adm. Code 125.200(a).
5. Upon receipt of a tax certification application, the Illinois EPA must file a recommendation on the application with the Board, 35 Ill Adm. Code 125.204(a).
6. Based on the information in the application and the purpose of the facility, it is the Illinois EPA's engineering judgment that the described facilities may be considered "pollution control facilities," pursuant to 35 Ill. Adm. Code 125.200(a), with the primary purpose of eliminating, preventing, or reducing water pollution, or as otherwise provided in 35 Ill. Adm. Code 125.200, and are eligible for tax certification from the Board.

WHEREFORE, the Illinois EPA recommends that the Board issue the requested tax certification.

ILLINOIS ENVIRONMENTAL PROTECTION AGENCY

By: 
Amanda Kimmel
Assistant Counsel
Division of Legal Counsel

Dated: December 3, 2024

Illinois Environmental Protection Agency
1021 North Grand Ave. E.
P.O. Box 19276
Springfield, Illinois 62794-9276
217/782-5544



ILLINOIS ENVIRONMENTAL PROTECTION AGENCY

1021 NORTH GRAND AVENUE EAST, P.O. BOX 19276, SPRINGFIELD, ILLINOIS 62794-9276 • (217) 782-3397

JB PRITZKER, GOVERNOR

JAMES JENNINGS, INTERIM DIRECTOR

Memorandum

To: Mike Roubitchek, Division of Legal Counsel

From: Darin E. LeCrone, P.E., Manager, Permit Section, Division of Water Pollution Control, Illinois Environmental Protection Agency *DE*

Date: OCT 16 2024

Re: Wabash Valley Service Company- Oblong
Recommendation of Tax Certification
Log No.: TC-148664
BOW ID No.: W0338060002
Property Index Number: 04-1-33-000-010

The Bureau of Water received a request on November 28, 2023 from Wabash Valley Service Company, having a principal place of business at 909 N. Court Street, Grayville, IL 62884 for an Illinois EPA recommendation regarding the tax certification of water pollution control facilities pursuant to 35 Il. Adm. Code 125.204. We offer the following recommendation.

The water pollution control facilities in this request include the following:

Wabash Valley Service Company
10154 N. 450th Ave
Oblong, IL 62449

Section 33, Township 7N, Range 13W of the 2nd PM in Crawford County.

Agrichemical containment facilities consisting of:

One (1) dry fertilizer storage building measuring 81 ft. (length) x 101 ft. (width) constructed of reinforced concrete walls (entire building is used for dry fertilizer storage). Total estimated storage capacity of 2,700 tons.

One (1) operational containment structure measuring 52 ft. (width) x 117 ft. (length) constructed of reinforced concrete. End loader transfer of bulk fertilizer between storage and the blender, unloading of bulk dry fertilizer transportation and application equipment, and the blending of bulk dry fertilizer is performed in this area.

One (1) operational containment structure measuring 12 ft. (width) x 16 ft. (length) constructed of reinforced concrete. The bulk dry fertilizer bucket elevator is located upon this structure.

One (1) operational containment structure measuring 20 ft. (width) x 30 ft. (length) constructed of reinforced concrete. Loading of bulk dry fertilizer transportation and application equipment is performed upon this structure.

2125 S. First Street, Champaign, IL 61820 (217) 278-5800
115 S. LaSalle Street, Suite 2203, Chicago, IL 60603
1101 Eastport Plaza Dr., Suite 100, Collinsville, IL 62234 (618) 346-5120
5911 Harrison Street, Des Plaines, IL 60016 (847) 294-4000

595 S. State Street, Elgin, IL 60123 (847) 608-3131
2309 W. Main Street, Suite 116, Marion, IL 62959 (618) 993-7200
412 SW Washington Street, Suite D, Peoria, IL 61602 (309) 671-3022
4302 N. Main Street, Rockford, IL 61103 (815) 987-7760

Page No. 1
Tax Certification Recommendation
Log No. TC-148664

These agrichemical facilities collect, store, or prevent the comingling of precipitation with agrichemical rinsates, residues, or washwaters prior to reuse or disposal as approved under the Agency endorsed Agrichemical Facility Permit No. AC91070680 (Log No. 21113480) issued on December 24, 2021.

These facilities are further described in the enclosed applications and supporting documents.

Based on the information included in this submittal, it is our engineering judgment that the above proposed facilities may be considered "Pollution Control Facilities" under 35 IAC 125.200(a), with the primary purpose of eliminating, preventing, or reducing water pollution, or as otherwise provided in this section, and therefore eligible for tax certification from the Illinois Pollution Control Board. The Bureau of Water therefore recommends that the Board issue the requested tax certification for these facilities.

If you have any questions regarding the above, please contact Stephanie Burge-Bollero at 217/557-8666.

SAB: TC-148664_Tax Cert Recommendation_13Sept24.docx

cc: Tax Cert File

Illinois EPA - Bureau of Water - Division of Pollution Control
Title 35 Subtitle A Part 125 Tax Certifications
Illinois EPA Review Notes for:
Agency Recommendation of Pollution Control Facilities.

BOW ID #: W0338060002

Project Name: Wabash Valley Service Company

Pollution Control Facility Type:
Agrichemical Facility

Date application received: 11/28/2023

Property ID: 04-01-33-000-010

Reviewer: SAB

Applicant: Wabash Valley Service Company
909 N. Court Street
Grayville, IL 62884

Log number: TC-148664

Legal Description:
Sections 33, Twp: 7N, Range: 13W of the 2nd PM

Facility: Wabash Valley Services
10154 N. 450th Ave
Oblong, IL 62449

County: Crawford

Date Control Devices installed: March 2014

Facility Contact: Kent A. Ochs
909 N. Court Street
Grayville, IL 62884

Application Signature by: Allen K Rusk

Title: Manager

Phone: 618/375-2311

Contents of Application: Application for Certification (Property Tax Treatment) Pollution Control Facility, Facility diagrams/drawings, Agrichemical Facility Permit

Is there a pollutant control flow diagram? Choose an item.
N/A

Is there sufficient diagrams showing the pollution control facilities? **Yes**

This facility generates the following pollutants and prevents their discharge as indicated:

Bulk agrichemical fertilizer and or pesticide rinsate and spillage is recycled at the facility and/or land applied to crop land.

Physical description of pollution control facilities that ARE recommended:

One (1) dry fertilizer storage building measuring 81 ft. (length) x 101 ft. (width) constructed of reinforced concrete walls (entire building is used for dry fertilizer storage). Total estimated storage capacity of 2,700 tons.

One (1) operational containment structure measuring 52 ft (width) x 117 ft. (length) constructed of reinforced concrete. End loader transfer of bulk fertilizer between storage and the blender, unloading of bulk dry fertilizer transportation and application equipment, and the blending of bulk dry fertilizer is performed in this area.

Illinois EPA Log #: TC-148664

Page 2 of 2

One (1) operational containment structure measuring 12 ft. (width) x 16 ft (length) constructed of reinforced concrete. The bulk dry fertilizer bucket elevator is located upon this structure.

One (1) operational containment structure measuring 20 ft. (width) x 30 ft. (length) constructed of reinforced concrete. Loading of bulk dry fertilizer transportation and application equipment is performed upon this structure.

These agrichemical facilities collect, store, or prevent the comingling of precipitation with agrichemical rinsates, residues, or washwaters prior to reuse or disposal as approved under the Agency endorsed Agrichemical Facility Permit No. AC91070680 (Log No. 21113480) issued on December 24, 2021.

Notes:

Nothing follows – SAB - (September 13, 2024)



Illinois Environmental Protection Agency

1021 North Grand Avenue East • P.O. Box 19276 • Springfield • Illinois • 62794-9276 • (217) 782-3397

Application for Certification (Property Tax Treatment) Pollution Control Facility

For Agency Use Only

File Number: TC-148664 Date Rec'd: 11/28/23
Certification Number: _____ Date: _____

Facility Type (check one): ☐ Air ☒ Water

This form is to be used for any application for certification of property tax treatment for a pollution control facility for air or water from the Illinois EPA. Separate applications must be completed for each pollution control facility claimed. Send the application only to the appropriate address listed below. Do not mix types (air and water). Where both air and water operations are related, send applications to each of the addresses.

If attachments are needed, record them consecutively on an index sheet.

Note: This form should be completed within Acrobat before being saved, printed, signed, and submitted.

Air: Illinois EPA

Attention: William D. Marr, Permit Section
Bureau of Air
1021 North Grand Avenue East, P.O. Box 19276
Springfield, IL 62794-9276

Water: Illinois EPA

Attention: Darin LeCrone, Permit Section
Bureau of Water
1021 North Grand Avenue East, P.O. Box 19276
Springfield, IL 62794-9276

I. Applicant Information

Company Name: Wabash Valley Service Company

| | |
|--|--|
| Person Authorized to Receive Certification Name: <u>Allen K. Rusk, General Manager</u> Street Addr: <u>909 N. Court Street</u> City: <u>Grayville</u> State: <u>IL</u> ZIP: <u>62884</u> Phone: <u>618/375-2311</u> Email: _____ | Person to Contact for Additional Information Name: <u>Kent A. Ochs</u> Street Addr: <u>909 N. Court Street</u> City: <u>Grayville</u> State: <u>IL</u> ZIP: <u>62884</u> Phone: <u>618/375-23111</u> Email: <u>kentochs@wabashvalleyfs.com</u> |
|--|--|

II. Facility Information

Facility Location: Quarter Section: S33 Township: T7N Range: 13W
Municipality: Oblong Township: Oblong

Note: A plat map location is requested for facilities located outside of municipal boundaries.

Address: 10154 N. 450th Ave City: Oblong
State: IL Zip Code: 62449 County: Crawford Book Number: _____

Property Index Number: 04-1-33-000-010 Note: The Property Index Number is the numerical reference used to identify a parcel of real property for assessment and taxation purposes.

Manufacturing Operations Information

Nature of Operations Conducted at the Above Location

Loading, unloading and storing of dry fertilizer .

Permit Information

WPC Construction Permit Number: AC91070680 Date Issued: Dec 24, 2021
NPDES Permit Number: _____ Date Issued: _____ Exp. Date: _____
APC Construction Permit Number: _____ Date Issued: _____
APC Operating Permit Number: _____ Date Issued: _____ Exp. Date: _____

Note: Submit copies of all relevant permits issued by local pollution control agencies (e.g. MSD Construction Permit).

This Agency is authorized to request this information under 415 ILCS 5/4(b)(2012). Disclosure of this information is voluntary and no penalties will result from the failure to provide the information. However, the absence of the information could prevent your application from being processed or could result in denial of your application.

IL 532-0222

APC 151 Rev. 5/2021

Application for Certification (Property Tax Treatment) Pollution Control Facility

Page 1 of 3

Manufacturing Process Information

Please provide information on the manufacturing process and materials on which pollution control facility is used, including each major piece of equipment associated with the pollution control facility (or low sulfur dioxide emission coal fueled device).

Description of the Process

Not Applicable

Materials Used in the Process

Not Applicable

Pollution Control Facility Information

Please provide a narrative description of the pollution control facility (or low sulfur dioxide emission coal fueled device), and an explanation of why its primary purpose is to eliminate, prevent or reduce pollution. State the type of control facility, as well as a narrative description and a process flow diagram describing the pollution control facility. Include an average analysis of the influent and effluent of the control facility stating the collection efficiency, if applicable.

Describe the Pollution Control Facility (or Low Sulfur Dioxide Emission Coal Fueled Device).

See Attached Addendum

Describe the Primary Purpose of the Pollution Control Facility (or Low Sulfur Dioxide Emission Coal Fueled Device).

The fertilizer storage structure is designed to eliminate, prevent or reduce surface runoff of fertilizer by covering the exposed areas to prevent exterior weather elements from coming in contact with residue that spills during normal operations of handling agriculture fertilizers and chemicals from storage to field applicators.

Identify the statute or regulation (federal or state), or local ordinance, if any, requiring the installation of the subject pollution control facility (or low sulfur dioxide emission coal fueled device).

Title 8 Ill. Admin. Code 255.140 (b) states that, "Non liquid fertilizers shall be stored inside a sound structure or device having a cover or rooftop, sidewalls and base sufficient to prevent contact with precipitation and surface waters."

Nature of Contaminants or Pollutants

List air contaminants or water pollution substances released as effluents to the manufacturing processes. Also list the final disposal of any contaminants removed from the manufacturing processes.

| Material Retained, Captured or Recovered | | |
|--|------------------|------------------------|
| Contaminant or Pollutant | Description | Disposal or Use |
| Dry Fertilizer | Spilled Products | Reduce, Recycle, Reuse |
| | | |
| | | |
| | | |
| | | |

Note: Contaminant or pollutant means that which is removed from the process by the pollution control facility.

Point(s) of Waste Water Discharge

Identify the location of the discharge to the receiving stream. This will typically refer to a source of water pollution but can include water-carried wastes from air pollution control facilities.

Plans and Specifications Attached: ☒ Yes ☐ No

Submit Drawings, which clearly show:

- Point(s) of discharge to receiving stream; and
- Sewers and process piping to and from the control facility.

Are contaminants (or residues) collected by the control facility? ☐ Yes ☒ No

Note: If the collected contaminants are disposed of other than as wastes, state the disposition of the materials, and the value dollars reclaimed by the sale or reuse of the collected substances. State the cost of reclamation and related expense.

Project Status

Date Installation Completed: March, 2014

Provide the date the pollution control facility was first placed into service and operated. If not, explain.

March, 2014

Status of installation on date of application

Operational

III. Verification and Signature

The following information is submitted in accordance with the Illinois Property Tax Code, as amended, and to the best of my knowledge is true and correct.

Any person who knowingly makes a false, fictitious, or fraudulent material statement, orally or in writing, to the Illinois EPA commits a Class 4 felony. A second or subsequent offense after conviction is a Class 3 felony. (415 ILCS 5/44(h))

For incorporated entities, signature should be from an authorized corporate representative.

Allen K. Rusk

Printed Name



Signature

General Manager

Title

11/20/2023

Date

Document Index

Wabash Valley Service Co. – Oblong Facility

- 1) Application (3 pages)
- 2) Document Index (1 page)
- 3) Addendum to Application (8 pages)

Addendum:

Dry Fertilizer/Agrichemical Facility:

Dry Fertilizer Storage and Concrete Containment:



Oblong Dry Fertilizer Storage and Operational Building



Oblong Dry Fertilizer Storage and Operational Building

The photographs above shows that the Dry fertilizer building is used exclusively for dry fertilizer storage. This building is described dimensionally in the Agrichemical Facility Permit AC91070680 Log# 2113480

Exhibit A. The building measures 81' wide x 101' long with an estimated storage capacity of 2,700 tons of fertilizers.

The three operational concrete containment structures that are described in the agrichemical facility permit are 1) (52' x 117') where the fertilizer is moved from the storage bins to the blender by an end loader, 2) (12' x 16') where the fertilizer moves from the blender to the bucket elevator which moves the fertilizer to an overhead loading area, and 3) (20' x 30') where the fertilizer is loaded into transportation and application equipment.

The storage portion on the dry building qualifies for certification based on Part 255.140 (a) of Title 8 Illinois Administrative Code, Chapter I Sub Chapter i. A recent Pollution Control Board Decision (PCB 24-23) certified the dry fertilizer concrete and the building over the concrete siting Part 255.140 as the justification for the certification. The dry fertilizer storage portion of the total building at Oblong makes up 100% of the building area. This area would be equivalent to 81' x 101' as described in the agrichemical facility permit cited above.

- The three concrete operational areas also qualify of certification. The concrete allows for spilled dry fertilizer to be swept up on a daily basis to prevent rain water from washing fertilizer residue off of the concrete structures onto the surrounding soil and ground water.

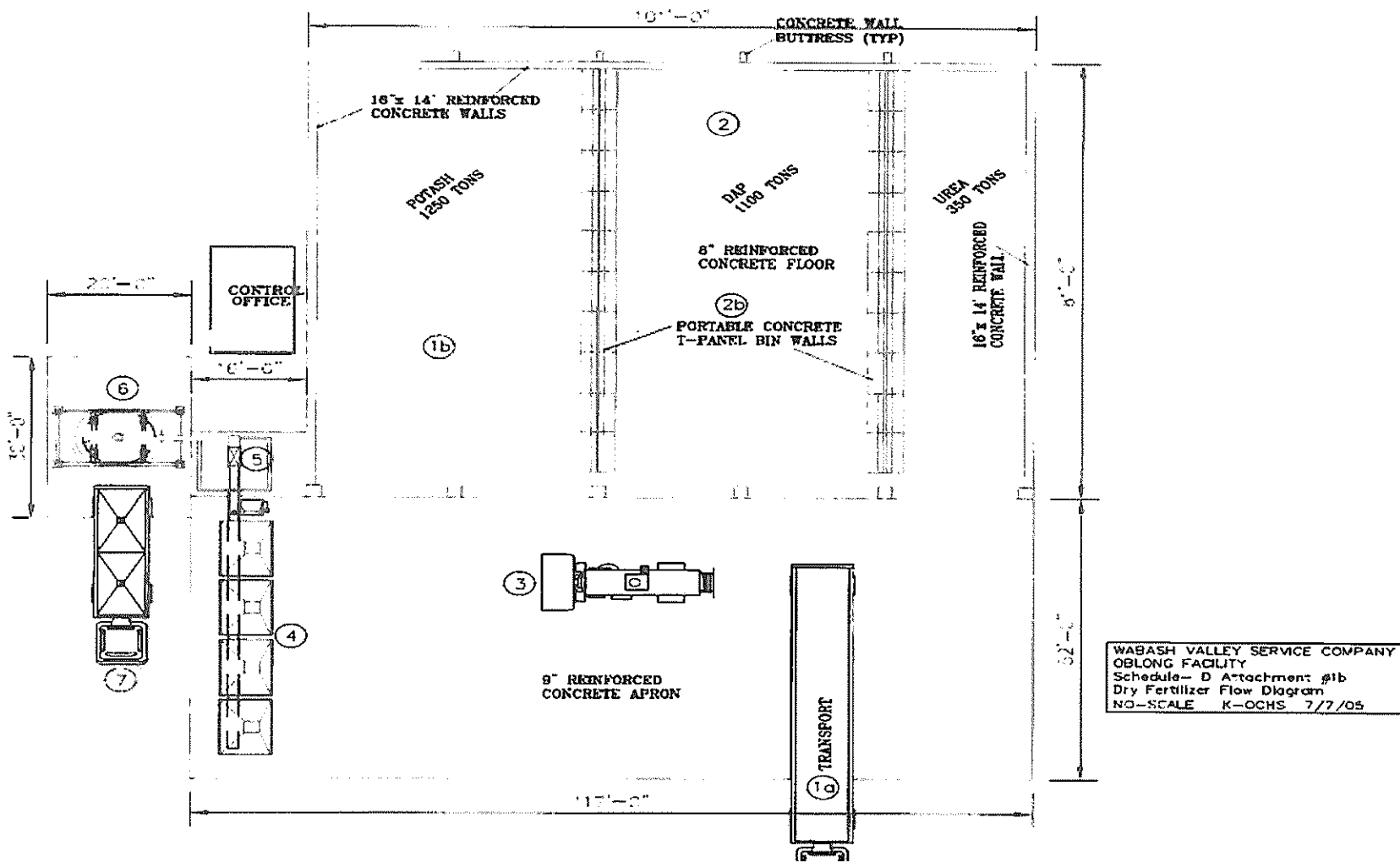

Floor Diagram of Oblong Dry Fertilizer Building and Operational Concrete

Exhibit A

Agrichemical Containment Permit

Oblong – Dry Fertilizer Storage and Operational Concrete

State of Illinois
Department of Agriculture
AGRICHEMICAL CONTAINMENT PERMIT

| | |
|---|--|
| Permittee: Wabash Valley Service Company 909 N. Court St. Grayville, IL 62844 | Facility ID Number: AC0333080000 Facility Location: Oblong |
| Permit #: AC91070680 Facility Type: Commercial: Retail Dealer Date Issued: December 24, 2021 | Log Number: 21113480 Date Received: November 8, 2021 Expiration Date: December 24, 2026 |

Permit is hereby granted to the above designated permittee to construct and operate an agrichemical containment facility as follows:

OPERATIONAL CONTAINMENT STRUCTURE

Operation of an existing reinforced concrete operational containment structure measuring 48' (width) x 48' (length) x 1' (depth) with a total design capacity of 1,013.9 cubic feet (ft.³). The floor shall slope to a series of four (4) sumps (two (2) sumps for the separation of solids and two (2) sumps for the recovery of liquids), each sump measuring 1.5' (width) x 1.5' (length) x 1.33' (depth) to facilitate the collection and recovery of all escaped product and/or agrichemical wastewater. All recovered effluent shall be transferred to one (1) of two (2) 1,600 gallon recovery tanks with a manually activated sump pump. Segregation shall be performed based upon the applicable target crop and label use. The loading, unloading and washing of bulk liquid agrichemical transportation and application equipment shall be performed upon the herein permitted structure.

SECONDARY CONTAINMENT STRUCTURES

Operation of an existing reinforced concrete secondary containment structure measuring 18' (width) x 20' (length) x 1.5' (height) with a total design capacity of 465.8 cubic feet (ft.³). The floor shall slope to a single sump measuring 1.5' (width) x 1.5' (length) x 0.75' (depth) to facilitate the collection and recovery of all escaped product and/or agrichemical wastewater. All recovered effluent shall be transferred to one (1) of the two (2) aforementioned 1,600 gallon recovery tanks with a manually activated sump pump. Segregation shall be performed based upon the applicable target crop and label use. All bulk liquid pesticides shall be stored within the herein permitted structure. This structure shall be referred to as SC-1.

Operation of an existing reinforced concrete secondary containment structure measuring 38' (width) x 46' (length) x 4' (height) with a total design capacity of 6,400.0 cubic feet (ft.³). The floor shall slope to a single sump measuring 1.5' (width) x 1.5' (length) x 0.75' (depth) to facilitate the collection and recovery of all escaped product and/or agrichemical wastewater. All recovered effluent shall be transferred to one (1) of the two (2) aforementioned 1,600 gallon recovery tanks with a manually activated sump pump. Segregation shall be performed based upon the applicable target crop and label use. All bulk liquid fertilizer shall be stored within the herein permitted structure. This structure shall be referred to as SC-2.



State of Illinois
Department of Agriculture
AGRICHEMICAL CONTAINMENT PERMIT

Operation of an existing reinforced concrete secondary containment structure measuring 48' (width) x 56' (length) x 0.5' (height) with a total design capacity of 1,383.0 cubic feet (ft.³). The floor shall slope to a single sump measuring 1.5' (width) x 1.5' (length) x 0.75' (depth) to facilitate the collection and recovery of all escaped product and/or agrichemical wastewater. All recovered effluent shall be transferred to one (1) of the two (2) aforementioned 1,600 gallon recovery tanks with a manually activated sump pump. Segregation shall be performed based upon the applicable target crop and label use. Mini-bulk and packaged agrichemicals shall be stored within the herein permitted structure. This structure shall be referred to as SC-3.

DRY FERTILIZER STRUCTURES

Operation of an existing bulk dry fertilizer storage building measuring 81' (width) x 101' (length) with an estimated total storage capacity of 2,700 tons. The structure is composed of three (3) storage bins (one (1) bin measuring 40' (width) x 81' (length) with an estimated storage capacity of 1,250 tons, one (1) bin measuring 40' (width) x 81' (length) with an estimated storage capacity of 1,100 tons, and one (1) bin measuring 20' (width) x 81' (length) with an estimated storage capacity of 350 tons).

All bulk dry fertilizer shall be stored within the herein permitted structure.

Operation of an existing reinforced concrete operational containment structure measuring 52' (width) x 117' (length). All end loader transfer of bulk dry fertilizer between storage and the blender, the unloading of bulk dry fertilizer transportation and application equipment, and the blending of bulk dry fertilizer shall be performed upon the herein permitted structure.

Operation of an existing reinforced concrete operational containment structure measuring 12' (width) x 16' (length). The bulk dry fertilizer bucket elevator shall be located upon the herein permitted structure.

Operation of an existing reinforced concrete operational containment structure measuring 20' (width) x 30' (length). All loading of bulk dry fertilizer transportation and application equipment shall be performed upon the herein permitted structure.

There shall be no discharge of wastewater from the herein permitted facilities.

This permit has been reviewed and approved by the Illinois Environmental Protection Agency per the attached permit endorsement. This permit is subject to standard conditions on the reverse side of this document and the following special conditions:

SPECIAL CONDITION 1: The permittee shall provide backflow protection in accordance with the Illinois Department of Public Health Plumbing Code (77 Ill. Adm. Code 890) and the Illinois Environmental Protection Agency's Technical Policy Statement (35 Ill. Adm. Code 653.803(c)(4)).

SPECIAL CONDITION 2: The permittee may discharge accumulated precipitation from the herein permitted bulk liquid fertilizer secondary containment structure (SC-2) pursuant to 8 Illinois Administrative Code 255.110 (a) (2) (A) and (B).

SPECIAL CONDITION 3: The permittee shall operate the exposed dry fertilizer operations pursuant to 8 Illinois Administrative Code 255.140 (a), (c) and (d).



State of Illinois
Department of Agriculture
AGRICHEMICAL CONTAINMENT PERMIT

SPECIAL CONDITION 4: The permittee shall employ concentric piping for the piping span from the bulk liquid fertilizer secondary containment structure (SC-2) to the operational containment structure.

SPECIAL CONDITION 5: The permittee shall provide means for the safe emergency access to and exit from the herein permitted bulk liquid fertilizer secondary containment structure (SC-2) pursuant to 8 Illinois Administrative Code 255.80 (c) (2) (E).

THE STANDARD CONDITIONS OF ISSUANCE ON THE REVERSE SIDES OF THIS MUST BE COMPLIED WITH IN FULL.

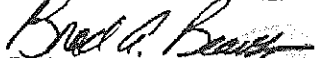
Brad Beaver, Acting Bureau Chief
Bureau of Environmental Programs

033308.pr

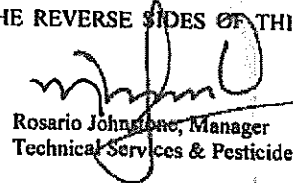
Rosario Johnson, Manager
Technical Services & Pesticide Laboratory

CC: IEPA WPC Permits
file



STATE OF ILLINOIS

COUNTY OF SANGAMON

)
)
)
)
)

CERTIFICATE OF SERVICE

I, the undersigned attorney at law, hereby certify that I have served on the date of December 3, 2024, the attached **NOTICE, APPEARANCE** and **RECOMMENDATION OF THE ILLINOIS ENVIRONMENTAL PROTECTION AGENCY**, upon the following persons by causing to be mailed a true copy thereof in an envelope duly addressed, bearing proper first class postage, and deposited in the United States mail at Springfield, Illinois:

Wabash Valley Service Company - Oblong
Kent Ochs
909 N. Court Street
Woodstock, Illinois 60098

Copies also provided electronically as follows:

Illinois Department of Revenue
via email at REV.PropTaxApp@illinois.gov
101 West Jefferson
P.O. Box 19033
Springfield, Illinois 62794

[Electronic Filing]

Clerk
Illinois Pollution Control Board
60 East Van Buren Street, Suite 630
Chicago, Illinois 60605

ILLINOIS ENVIRONMENTAL PROTECTION AGENCY

/s/ Amanda Kimmel
Assistant Counsel
Division of Legal Counsel
1021 North Grand Avenue East
P.O. Box 19276
Springfield, Illinois 62794-9276
217.782.5544
217.782.9143 (TDD)